

Organize the tube parts:

- place the tube parts on the floor in the layout as shown below

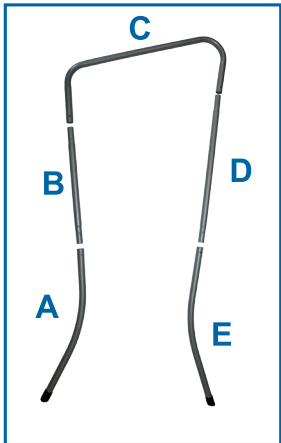

Connect the tube parts:

- press down on the pin
- slide the tube into the other tube, while pressing down on the pin
- the 2 tubes are connected when the pin clicks into the hole

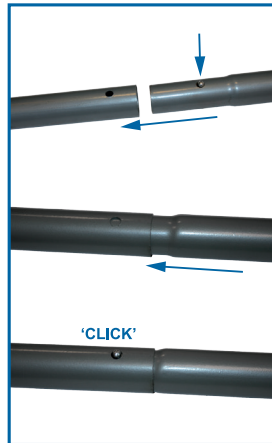

Prepare the brackets for installation:

- unscrew the 2 bolts of each bracket
- locate the small pin inside each bracket
- this pin connects to a hole in the frame of the step support

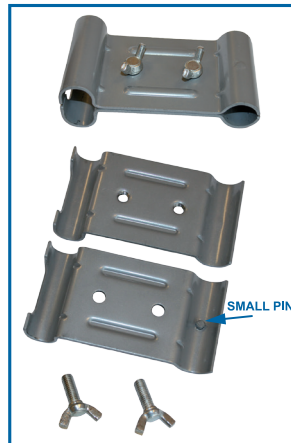

Prepare the brackets for installation:

- place the bracket parts next to the step as shown below (support on right side of step)
- for placement of support on the left side of the step, please mirror the positions below



Finish the installation:

- place the frame next to the double step and fixate the 2 brackets to the double step and the frame with the bolts
- make sure to tighten the bolts as much as possible for optimal steady support

